

ACCOLIFT® CLH HOISTS - HOOK SUSPENSION

SINGLE PHASE / SINGLE SPEED HOOK SUSPENSION

Cap. (Tons)	Model Number	Std. Lift (ft.)	Push Button Cord Length (ft.)	Lifting Speed (fpm)	Hoist Motor			Load Chain Diameter (in.) X Chain Fall Lines	Add'l 1 ft. of Lift (lbs.)	Net Wt. (lbs.)
					HP	Amp. Draw				
						115V	208/230V			
1/2	2330010	20	18	14	1.1	24.0	13.1/12.0	.280 x (1)	0.75	139
1	2330020			14	1.1	24.0	13.1/12.0	.280 x (1)	0.75	139
2	2330040			7	1.1	24.0	13.1/12.0	.280 x (2)	1.5	172

SINGLE PHASE / INVERTER CONTROL HOOK SUSPENSION

Cap. (Tons)	Model Number	Std. Lift (ft.)	Push Button Cord Length (ft.)	Lifting Speed (fpm)	Hoist Motor			Load Chain Diameter (in.) X Chain Fall Lines	Add'l 1 ft. of Lift (lbs.)	Net Wt. (lbs.)
					HP	Amp. Draw				
						115V	208/230V			
1/2	2330010-VFD-230-1	20	18	27/9	2.4	-	9.2/8.4	.280 x (1)	0.75	148
1	2330020-VFD-230-1			27/9	2.4	-	9.2/8.4	.280 x (1)	0.75	148
2	2330040-VFD-230-1			13/4	2.4	-	9.2/8.4	.280 x (2)	1.5	181
3	See model 2130060-VFD-230-1 on page 12.									

THREE PHASE / SINGLE SPEED HOOK SUSPENSION

Cap. (Tons)	Model Number	Std. Lift (ft.)	Push Button Cord Length (ft.)	Lifting Speed (fpm)	Hoist Motor			Load Chain Diameter (in.) X Chain Fall Lines	Add'l 1 ft. of Lift (lbs.)	Net Wt. (lbs.)
					HP	Amp. Draw				
						208/230V	460V			
1/2	2230010	20	18	17	2.0	8.8/8.0	4.0	.280 x (1)	0.75	134
1	2230020			17	2.0	8.8/8.0	4.0	.280 x (1)	0.75	134
2	2230040			9	2.0	8.8/8.0	4.0	.280 x (2)	1.5	168

THREE PHASE / INVERTER CONTROL HOOK SUSPENSION

Cap. (Tons)	Model Number	Std. Lift (ft.)	Push Button Cord Length (ft.)	Lifting Speed (fpm)	Hoist Motor			Load Chain Diameter (in.) X Chain Fall Lines	Add'l 1 ft. of Lift (lbs.)	Net Wt. (lbs.)
					HP	Amp. Draw				
						208/230V	460V			
1/2	2230010-VFD	20	18	27/9	2.4	9.2/8.4	4.2	.280 x (1)	0.75	146
1	2230020-VFD			27/9	2.4	9.2/8.4	4.2	.280 x (1)	0.75	146
2	2230040-VFD			13/4	2.4	9.2/8.4	4.2	.280 x (2)	1.5	181

DIMENSIONS - HOOK SUSPENSION

Figure A

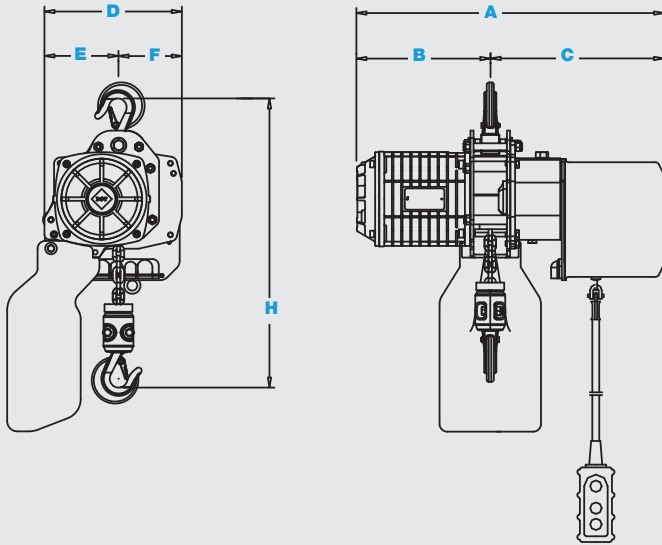
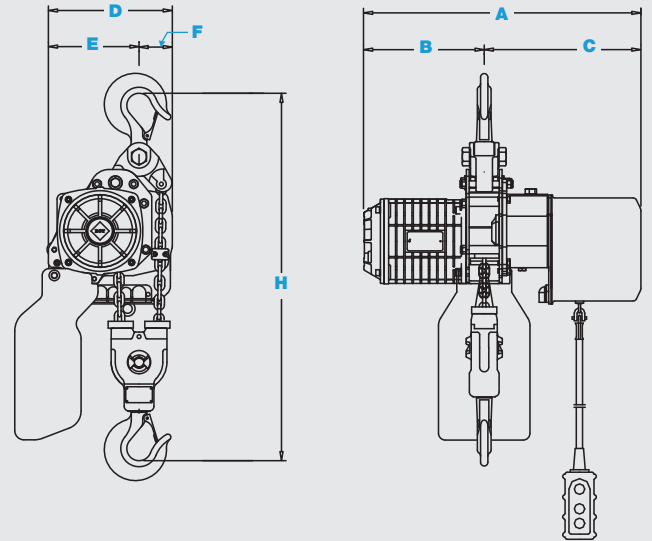

Figure B



Dimensions in Inches (Nominal). *For hook dimensions, see page 10.*

Model Number	A	B	C	D	E	F	H	Figure
2230010	20.7	10.4	10.3	10.7	5.8	4.9	15.8	A
2230020	20.7	10.4	10.3	10.7	5.8	4.9	15.8	A
2230040	20.7	10.4	10.3	10.7	7.8	2.9	26.8	B
2230010-VFD	23.9	10.4	13.5	13	5.8	7.2	15.8	A
2230020-VFD	23.9	10.4	13.5	13	5.8	7.2	15.8	A
2230040-VFD	23.9	10.4	13.5	13	7.8	5.2	26.8	B
2330010	21.5	10.4	11.1	10.7	5.8	4.9	15.8	A
2330020	21.5	10.4	11.1	10.7	5.8	4.9	15.8	A
2330040	21.5	10.4	11.1	10.7	7.8	2.9	26.8	B
2330010-VFD-230-1	23.9	10.4	13.5	10.7	5.8	4.9	15.8	A
2330020-VFD-230-1	23.9	10.4	13.5	10.7	5.8	4.9	15.8	A
2330040-VFD-230-1	23.9	10.4	13.5	10.7	7.8	2.9	26.8	B

ACCOLIFT® CLH HOISTS - PUSH / PULL TROLLEY

SINGLE PHASE / SINGLE SPEED PUSH / PULL TROLLEY

Cap. (Tons)	Model Number	Std. Lift (ft.)	Push Button Cord Length (ft.)	Lifting Speed (fpm)	Hoist Motor			Flange Width Adjustability (in.)	Wheel Diameter (in.)	Min. Beam Radius (in.)	Load Chain Diameter (in.) X Chain Fall Lines	Add'l 1 ft. of Lift (lbs.)	Net Wt. (lbs.)
					HP	Amp. Draw							
						115V	208/ 230V						
1/2	2330010-PT	20	18	14	1.1	24.0	13.1/12.0	3.25 to 12	3.7	32	.280 x (1)	0.75	161
1	2330020-PT			14	1.1	24.0	13.1/12.0	3.25 to 12	3.7	32	.280 x (1)	0.75	161
2	2330040-PT			7	1.1	24.0	13.1/12.0	3.25 to 12	4.3	32	.280 x (2)	1.5	209

SINGLE PHASE / INVERTER CONTROL PUSH / PULL TROLLEY

Cap. (Tons)	Model Number	Std. Lift (ft.)	Push Button Cord Length (ft.)	Lifting Speed (fpm)	Hoist Motor			Flange Width Adjustability (in.)	Wheel Diameter	Min. Beam Radius (in.)	Load Chain Diameter (in.) X Chain Fall Lines	Add'l 1 ft. of Lift (lbs.)	Net Wt. (lbs.)
					HP	Amp. Draw							
						208/ 230V							
1/2	2330010-VFD-230-1-PT	20	18	27/9	2.4	9.2/8.4		3.25 to 12	3.7	32	.280 x (1)	0.75	157
1	2330020-VFD-230-1-PT			27/9	2.4	9.2/8.4		3.25 to 12	3.7	32	.280 x (1)	0.75	157
2	2330040-VFD-230-1-PT			13/4	2.4	9.2/8.4		3.25 to 12	4.3	32	.280 x (2)	1.5	205
3	See model 2130060-VFD-230-1-PT on page 14.												

THREE PHASE / SINGLE SPEED PUSH / PULL TROLLEY

Cap. (Tons)	Model Number	Std. Lift (ft.)	Push Button Cord Length (ft.)	Lifting Speed (fpm)	Hoist Motor			Flange Width Adjustability (in.)	Wheel Diameter (in.)	Min. Beam Radius (in.)	Load Chain Diameter (in.) X Chain Fall Lines	Add'l 1 ft. of Lift (lbs.)	Net Wt. (lbs.)
					HP	Amp. Draw							
						208/ 230V	460V						
1/2	2230010-PT	20	18	17	2.0	8.8/8.0	4.0	3.25 to 12	3.7	32	.280 x (1)	0.75	167
1	2230020-PT			17	2.0	8.8/8.0	4.0	3.25 to 12	3.7	32	.280 x (1)	0.75	167
2	2230040-PT			9	2.0	8.8/8.0	4.0	3.25 to 12	4.3	32	.280 x (2)	1.5	216

THREE PHASE / INVERTER CONTROL PUSH / PULL TROLLEY

Cap. (Tons)	Model Number	Std. Lift (ft.)	Push Button Cord Length (ft.)	Lifting Speed (fpm)	Hoist Motor			Flange Width Adjustability (in.)	Wheel Diameter	Min. Beam Radius (in.)	Load Chain Diameter (in.) X Chain Fall Lines	Add'l 1 ft. of Lift (lbs.)	Net Wt. (lbs.)
					HP	Amp. Draw							
						208/ 230V	460V						
1/2	2230010-VFD-PT	20	18	27/9	2.4	9.2/8.4	4.2	3.25 to 12	3.7	32	.280 x (1)	0.75	167
1	2230020-VFD-PT			27/9	2.4	9.2/8.4	4.2	3.25 to 12	3.7	32	.280 x (1)	0.75	167
2	2230040-VFD-PT			13/4	2.4	9.2/8.4	4.2	3.25 to 12	4.3	32	.280 x (2)	1.5	216

DIMENSIONS - PUSH / PULL TROLLEY

Figure A

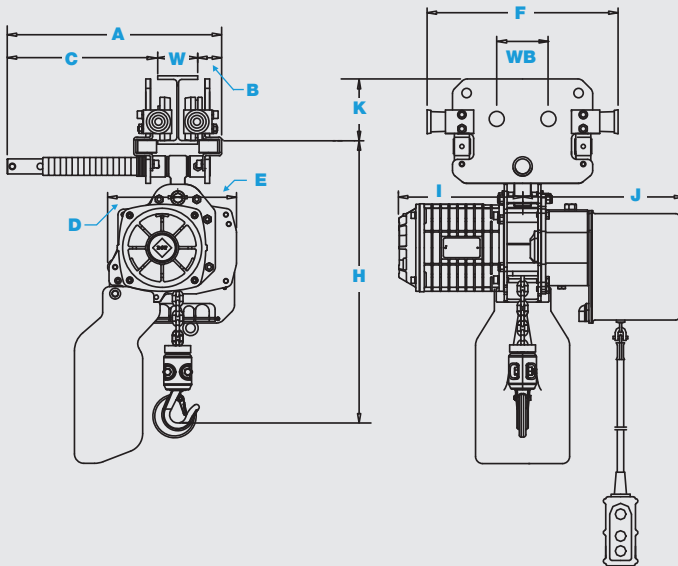
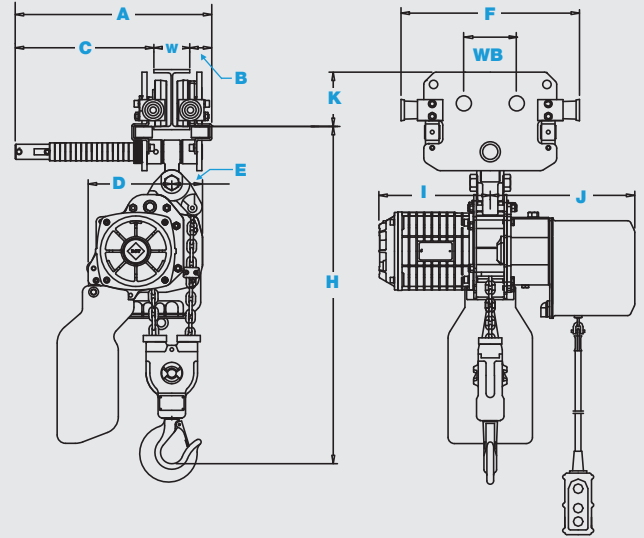

Figure B



Dimensions in Inches (Nominal). **For hook dimensions, see page 10.**

Model Number	A	B	C	D	E	F	H	I	J	K	WB	Figure
			W = Beam width									
2230010-PT	17	1.8	15.2-W	5.8	4.9	16	17.5	10.4	10.3	5.2	4.4	A
2230020-PT	17	1.8	15.2-W	5.8	4.9	16	17.5	10.4	10.3	5.2	4.4	A
2230040-PT	17.5	1.8	15.7-W	7.8	2.9	16.7	26	10.4	10.3	5.2	4.9	B
2230010-VFD-PT	17	1.8	15.2-W	5.8	7.1	16	17.5	10.4	13.5	5.2	4.4	A
2230020-VFD-PT	17	1.8	15.2-W	5.8	7.1	16	17.5	10.4	13.5	5.2	4.4	A
2230040-VFD-PT	17.5	1.8	15.7-W	7.8	5.1	16.7	26	10.4	13.5	5.2	4.9	B
2330010-PT	17	1.8	15.2-W	5.8	4.9	16	17.5	10.4	11.1	5.2	4.4	A
2330020-PT	17	1.8	15.2-W	5.8	4.9	16	17.5	10.4	11.1	5.2	4.4	A
2330040-PT	17.5	1.8	15.7-W	7.8	2.9	16.7	26	10.4	11.1	5.2	4.9	B
2330010-VFD-1-PT	17	1.8	15.2-W	5.8	4.9	16	17.5	10.4	13.5	5.2	4.4	A
2330020-VFD-1-PT	17	1.8	15.2-W	5.8	4.9	16	17.5	10.4	13.5	5.2	4.4	A
2330040-VFD-1-PT	17.5	1.8	15.7-W	7.8	2.9	16.7	26	10.4	13.5	5.2	4.9	B

ACCOLIFT® CLH HOISTS - MOTORIZED TROLLEY

SINGLE PHASE / SINGLE SPEED MOTORIZED TROLLEY

Cap. (Tons)	Model Number	Std. Lift (ft.)	Push Button Cord Length (ft.)	Lifting Speed (fpm)	Trolley Speed (fpm)	Hoist Motor			Trolley Motor			Flange Width Adjustability (in.)	Wheel Dia.	Min. Beam Radius (in.)	Load Chain Diameter (in.) X Chain Fall Lines	Add'l 1 ft. of Lift (lbs.)	Net Wt. (lbs.)
						HP	Amp. Draw		HP	Amp. Draw							
							115V	208/230V		115V	208/230V						
1/2	2330110	20	18	14	36	1.1	24.0	13.1/12.0	0.27	7.8	4.3/3.9	3.25 to 12	3.7	32	.280 x (1)	0.75	225
1	2330120			14	36	1.1	24.0	13.1/12.0	0.27	7.8	4.3/3.9	3.25 to 12	3.7	32	.280 x (1)	0.75	225
2	2330140			7	36	1.1	24.0	13.1/12.0	0.27	7.8	4.3/3.9	3.25 to 12	4.3	32	.280 x (2)	1.5	273

SINGLE PHASE / INVERTER CONTROL MOTORIZED TROLLEY

Cap. (Tons)	Model Number	Std. Lift (ft.)	Push Button Cord Length (ft.)	Lifting Speed (fpm)	Trolley Speed (fpm)	Hoist Motor			Trolley Motor			Flange Width Adjustability (in.)	Wheel Dia.	Min. Beam Radius (in.)	Load Chain Diameter (in.) X Chain Fall Lines	Add'l 1 ft. of Lift (lbs.)	Net Wt. (lbs.)
						HP	Amp. Draw		HP	Amp. Draw							
							115V	208/230V		115V	208/230V						
1/2	2330110-VFD-230-1	20	18	27/9	75/25	2.4	-	9.2/8.4	0.54	-	3.3/3.0	3.25 to 12	3.7	32	.280 x (1)	0.75	227
1	2330120-VFD-230-1			27/9	75/25	2.4	-	9.2/8.4	0.54	-	3.3/3.0	3.25 to 12	3.7	32	.280 x (1)	0.75	227
2	2330140-VFD-230-1			13/4	75/25	2.4	-	9.2/8.4	0.54	-	3.3/3.0	3.25 to 12	4.3	32	.280 x (2)	1.5	280
3	See model 2130160-VFD-230-1 on page 16.																

THREE PHASE / SINGLE SPEED MOTORIZED TROLLEY

Cap. (Tons)	Model Number	Std. Lift (ft.)	Push Button Cord Length (ft.)	Lifting Speed (fpm)	Trolley Speed (fpm)	Hoist Motor			Trolley Motor			Flange Width Adjustability (in.)	Wheel Dia.	Min. Beam Radius (in.)	Load Chain Diameter (in.) X Chain Fall Lines	Add'l 1 ft. of Lift (lbs.)	Net Wt. (lbs.)
						HP	Amp. Draw		HP	Amp. Draw							
							208/230V	460V		208/230V	460V						
1/2	2230110	20	18	17	36	2.0	8.8/8.0	4.0	0.54	3.3/3.0	1.5	3.25 to 12	3.7	32	.280 x (1)	0.75	221
1	2230120			17	36	2.0	8.8/8.0	4.0	0.54	3.3/3.0	1.5	3.25 to 12	3.7	32	.280 x (1)	0.75	221
2	2230140			9	36	2.0	8.8/8.0	4.0	0.54	3.3/3.0	1.5	3.25 to 12	4.3	32	.280 x (2)	1.5	269

THREE PHASE / INVERTER CONTROL MOTORIZED TROLLEY

Cap. (Tons)	Model Number	Std. Lift (ft.)	Push Button Cord Length (ft.)	Lifting Speed (fpm)	Trolley Speed (fpm)	Hoist Motor			Trolley Motor			Flange Width Adjustability (in.)	Wheel Dia.	Min. Beam Radius (in.)	Load Chain Diameter (in.) X Chain Fall Lines	Add'l 1 ft. of Lift (lbs.)	Net Wt. (lbs.)
						HP	Amp. Draw		HP	Amp. Draw							
							208/230V	460V		208/230V	460V						
1/2	2230110-VFD	20	18	27/9	75/25	2.4	9.2/8.4	4.2	0.54	3.3/3.0	1.5	3.25 to 12	3.7	32	.280 x (1)	0.75	231
1	2230120-VFD			27/9	75/25	2.4	9.2/8.4	4.2	0.54	3.3/3.0	1.5	3.25 to 12	3.7	32	.280 x (1)	0.75	231
2	2230140-VFD			13/4	75/25	2.4	9.2/8.4	4.2	0.54	3.3/3.0	1.5	3.25 to 12	4.3	32	.280 x (2)	1.5	280

DIMENSIONS - MOTORIZED TROLLEY

Figure A

Figure B

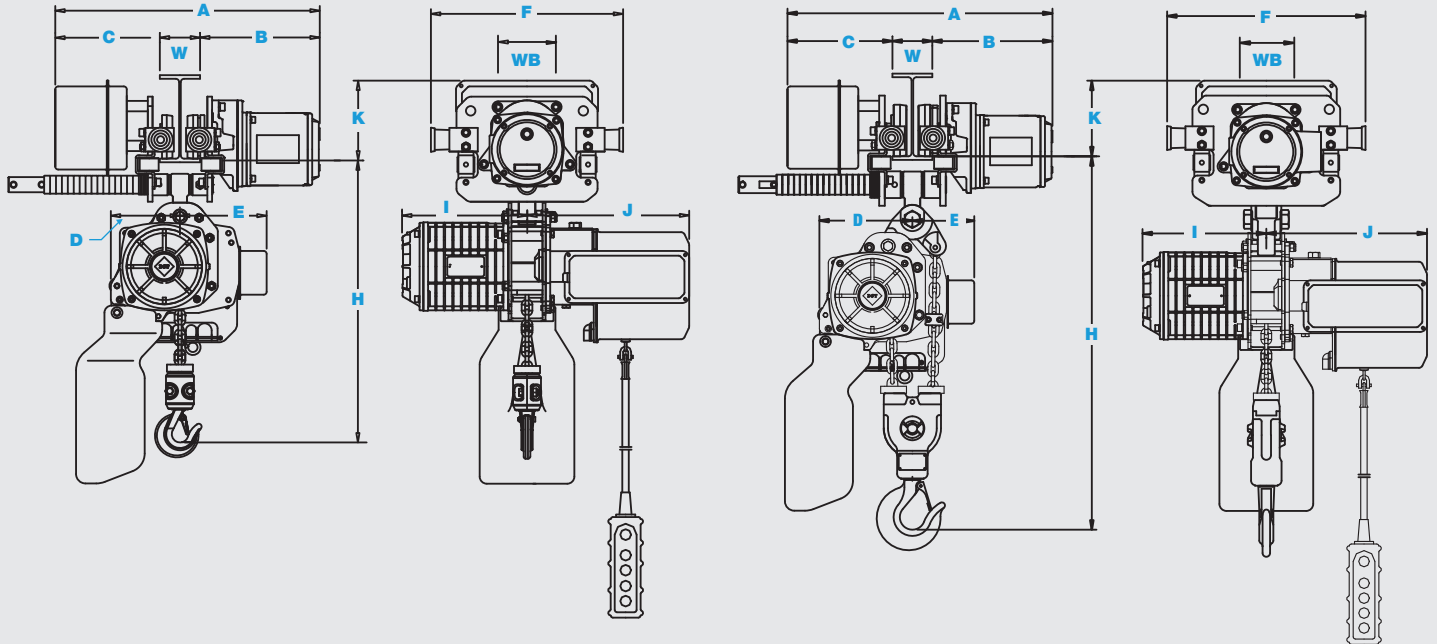

Dimensions in Inches (Nominal). *For hook dimensions, see page 10.*

Model Number	A	B	C	D	E	F	H	I	J	K	WB	Figure
2230110	16.7 + W	10	6.7	5.8	4.9	16	17.5	10.4	10.3	6.5	4.4	A
2230120	16.7 + W	10	6.7	5.8	4.9	16	17.5	10.4	10.3	6.5	4.4	A
2230140	16.9 + W	10.1	6.8	7.8	2.9	16.7	26	10.4	10.3	6.4	4.9	B
2230110-VFD	18.7 + W	10	8.7	5.8	7.2	16	17.5	10.4	13.5	6.5	4.4	A
2230120-VFD	18.7 + W	10	8.7	5.8	7.2	16	17.5	10.4	13.5	6.5	4.4	A
2230140-VFD	18.9 + W	10.1	8.8	7.8	5.2	16.7	26	10.4	13.5	6.4	4.9	B
2330110	20.3 + W	11.6	8.7	5.8	4.9	16	17.5	10.4	11.1	6.5	4.4	A
2330120	20.3 + W	11.6	8.7	5.8	4.9	16	17.5	10.4	11.1	6.5	4.4	A
2330140	20.6 + W	11.8	8.8	7.8	2.9	16.7	26	10.4	11.1	6.4	4.9	B
2330110-VFD-230-1	18.7 + W	10	8.7	5.8	4.9	16	17.5	10.4	13.5	6.5	4.4	A
2330120-VFD-230-1	18.7 + W	10	8.7	5.8	4.9	16	17.5	10.4	13.5	6.5	4.4	A
2330140-VFD-230-1	18.9 + W	10.1	8.8	7.8	2.9	16.7	26	10.4	13.5	6.4	4.9	B

ACCOLIFT® CLH HOISTS - HOOK DIMENSIONS & CHAIN CONTAINER CAPACITIES

ACCOLIFT® CLH HOISTS - HOOK DIMENSIONS

Dimensions in Inches (Nominal)

Capacity	A	B	C	D	E
1/2 Ton	0.95	3.82	1.24	1.38	0.93
1 Ton	0.95	3.82	1.24	1.38	0.93
2 Ton	1.18	5.73	1.69	2.11	1.54

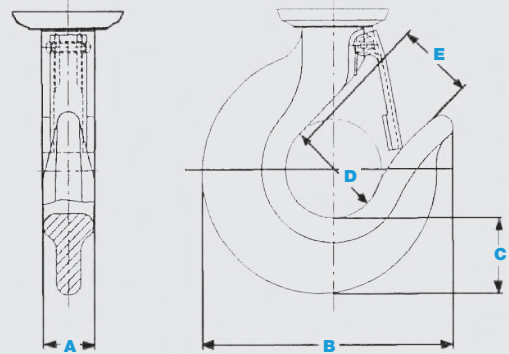

ACCOLIFT® CLH HOISTS - CHAIN CONTAINER CAPACITIES

Hoist Capacity	Max. Lift With Standard Chain Bucket (ft.)	Max. Lift With Optional Chain Bucket (ft.)	Max. Lift With Optional Canvas Chain Bag (ft.)
1/2 Ton	39 (71964-107)	49 (71574-1038)	40 (71574-1264)
1 Ton	39 (71964-107)	49 (71574-1038)	40 (71574-1264)
2 Ton	25 (71964-207) or	65 (71574-1039)	20 (71574-1264)

Buckets may be available for longer lifts than stated above - please call factory with your application.

DIMENSIONS - HOOK SUSPENSION

1 TO 5 TON HOOK SUSPENSION HOISTS:

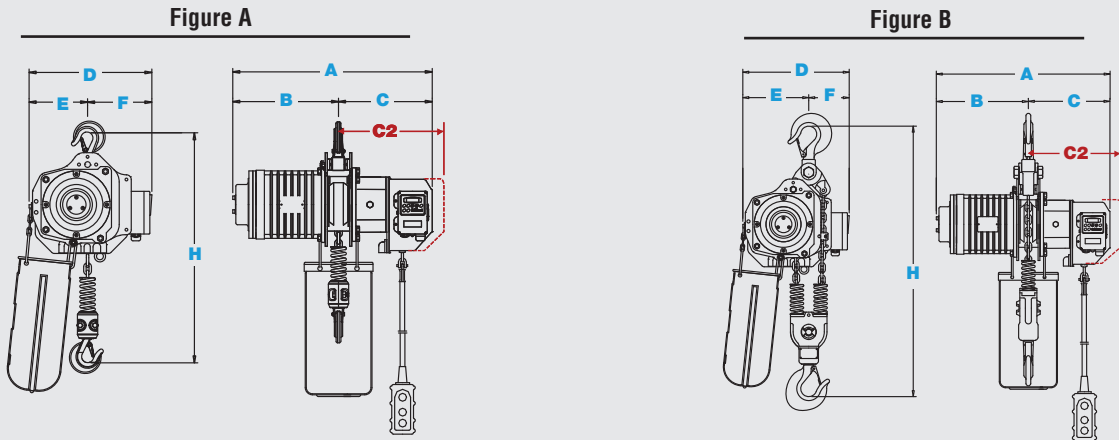

Dimensions in Inches (Nominal). *For hook dimensions, see page 18.*

Model Number	A	B	C	C2*	D	E	F	H	Figure
2130020	22.9	12.1	10.8	-	14.2	6.7	7.5	20	A
2130030	22.9	12.1	10.8	12.8	14.2	6.7	7.5	20	A
2130040	22.9	12.1	10.8	-	14.2	8.9	5.3	30	B
2130050	26.4	14.1	12.3	13.5	16.8	7.7	9.1	28.5	A
2130060	26.4	14.1	12.3	13.5	16.8	10.2	6.6	36	B
2130060-VFD-230-1	27.6	14.1	13.5	13.5	16.8	10.2	6.6	36	B
2130065	26.4	14.1	12.3	13.5	16.8	7.7	9.1	30	A
2130070	26.4	14.1	12.3	13.5	16.8	10.7	6.1	42	B
2130075	26.4	14.1	12.3	13.5	21.2	12.8	8.4	57.7	C
2130080	28.2	14.1	14.1	14.1	48.8	24.4	24.4	57.4	D
2130090	30	15	15	16.2	53.9	27	27	70.4	D
2130095	31.8	15.9	15.9	17.1	53.9	27	27	70.4	D

* Inverter Control Models only.

7-1/2 TON HOOK SUSPENSION HOIST:

Figure C

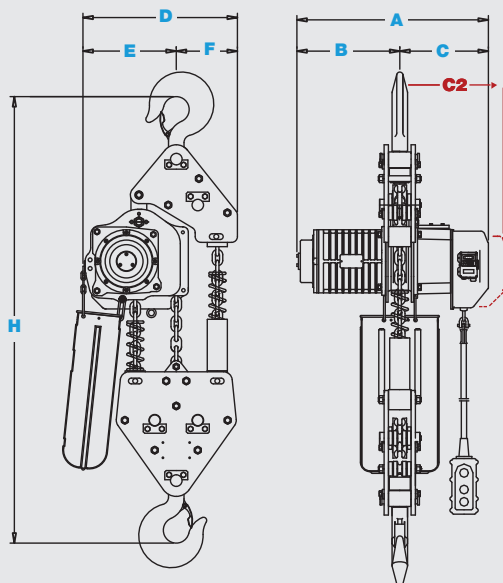

10 TON TO 20 TON HOOK SUSPENSION HOISTS:

Figure D

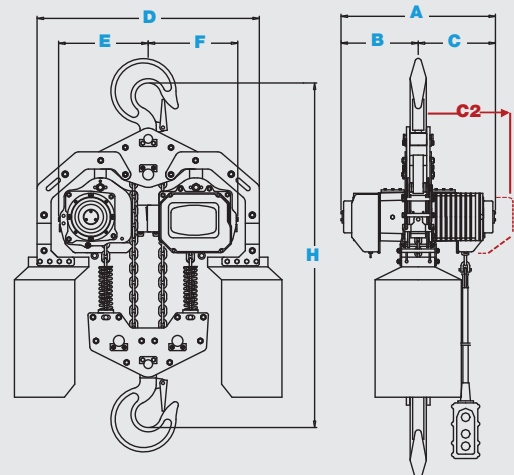

ACCOLIFT® HOISTS - PUSH / PULL TROLLEY

SINGLE SPEED PUSH / PULL TROLLEY

Cap. (Tons)	Model Number	Std. Lift (ft.)	Push Button Cord Length (ft.)	Lifting Speed (fpm)	Hoist Motor			Flange Width Adjustability (in.)	Wheel Diameter	Min. Beam Radius (in.)	Load Chain Diameter (in.) X Chain Fall Lines	Add'l 1 ft. of Lift (lbs.)	Net Wt. (lbs.)
					HP	Amp. Draw							
						208/ 230V	460V						
1	2130020-PT	20	18	17	2.0	8.8/8.0	4.0	3.25 to 12	3.7	32	.280 x (1)	0.75	174
1	2130030-PT			27	2.4	9.2/8.4	4.2	3.25 to 12	3.7	32	.280 x (1)	0.75	174
2	2130040-PT			13	2.4	9.2/8.4	4.2	3.25 to 12	4.3	32	.280 x (2)	1.5	229
2	2130050-PT			27	4.7	17.2/15.8	7.9	3.25 to 12	4.3	32	.441 x (1)	1.84	260
3	2130060-PT			17	4.7	17.2/15.8	7.9	3.25 to 12	4.9	40	.374 x (2)	2.62	404
3	2130065-PT			21	4.7	17.2/15.8	7.9	3.25 to 12	4.9	40	.441 x (1)	1.84	293
5	2130070-PT			11	4.7	17.2/15.8	7.9	3.25 to 12	5.5	72*	.441 x (2)	3.68	523

INVERTER CONTROL PUSH / PULL TROLLEY

Cap. (Tons)	Model Number	Std. Lift (ft.)	Push Button Cord Length (ft.)	Lifting Speed (fpm)	Hoist Motor			Flange Width Adjustability (in.)	Wheel Diameter	Min. Beam Radius (in.)	Load Chain Diameter (in.) X Chain Fall Lines	Add'l 1 ft. of Lift (lbs.)	Net Wt. (lbs.)
					HP	Amp. Draw							
						208/ 230V	460V						
1	2130030-VFD-PT	20	18	21/7	2.4	9.2/8.4	4.2	3.25 to 12	3.7	32	.280 x (1)	0.75	174
2	2130050-VFD-PT			21/7	4.7	17.2/15.8	7.9	3.25 to 12	4.3	32	.441 x (1)	1.84	260
3	2130060-VFD-PT			15/5	4.7	17.2/15.8	7.9	3.25 to 12	4.9	40	.374 x (2)	2.62	404
3	2130060-VFD-230-1-PT			15/5	4.7	17.2/15.8	-	3.25 to 12	4.9	40	.374 x (2)	2.62	404
3	2130065-VFD-PT			21/7	4.7	17.2/15.8	7.9	3.25 to 12	4.9	40	.441 x (1)	1.84	293
5	2130070-VFD-PT			11/4	4.7	17.2/15.8	7.9	3.25 to 12	5.5	72*	.441 x (2)	3.68	523

* Applies to a beam flange width of 4" and over.



DIMENSIONS - PUSH / PULL TROLLEY

1 TO 5 TON PUSH / PULL TROLLEY HOISTS:

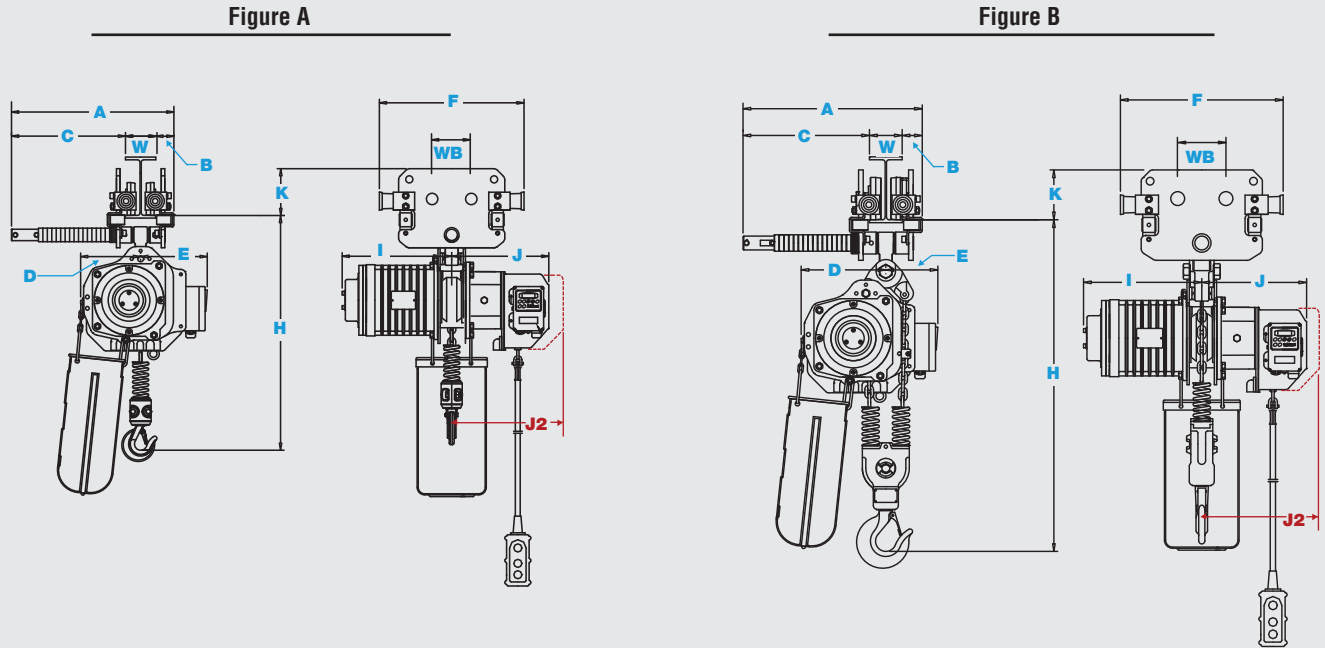

Dimensions in Inches (Nominal). *For hook dimensions, see page 18.*

Model Number	A	B	C W = Beam width	D	E	F	H	I	J	J2*	K	WB	Figure
2130020-PT	17.9	2	15.9-W	6.7	7.5	16	21.5	12.1	10.8	-	5.2	4.4	A
2130030-PT	17.9	2	15.9-W	6.7	7.5	16	21.5	12.1	10.8	12.8	5.2	4.4	A
2130040-PT	18.3	2.1	16.2-W	8.9	5.3	16.7	29.3	12.1	10.8	-	5.1	4.9	B
2130050-PT	18.3	2.1	16.2-W	7.7	9.1	16.7	28.2	14.1	12.3	13.5	5.1	4.9	A
2130060-PT	18.3	2	16.3-W	10.2	6.6	18	36.2	14.1	12.3	13.5	5.8	5.5	B
2130060-VFD-230-1-PT	18.3	2	16.3-W	10.2	6.6	18	36.2	14.1	13.5	13.5	5.8	5.5	B
2130065-PT	18.3	2	16.3-W	7.7	9.1	18	28.8	14.1	12.3	13.5	5.8	5.5	A
2130070-PT	19.2	2.2	17-W	10.7	6.1	20	41.7	14.1	12.3	13.5	5.7	6.1	B

* Inverter Control Models only.

ACCOLIFT® HOISTS - MOTORIZED TROLLEY

SINGLE SPEED MOTORIZED TROLLEY

Cap. (Tons)	Model Number	Std. Lift (ft.)	Push Button Cord Length (ft.)	Lifting Speed (fpm)	Trolley Speed (fpm)	Hoist Motor			Trolley Motor			Flange Width Adjustability (in.)	Wheel Dia.	Min. Beam Radius (in.)	Load Chain Diameter (in.) X Chain Fall Lines	Add'l 1 ft. of Lift (lbs.)	Net Wt. (lbs.)
						HP	Amp. Draw		HP	Amp. Draw							
							208/230V	460V		208/230V	460V						
1	2130120	20	18	17	36	2.0	8.8/8.0	4.0	0.54	3.3/3.0	1.5	3.25 to 12	3.7	32	.280 x (1)	0.75	238
1	2130130			27	36	2.4	9.2/8.4	4.2	0.54	3.3/3.0	1.5	3.25 to 12	3.7	32	.280 x (1)	0.75	238
2	2130140			13	36	2.4	9.2/8.4	4.2	0.54	3.3/3.0	1.5	3.25 to 12	4.3	32	.280 x (2)	1.5	293
2	2130150			27	36	4.7	17.2/15.8	7.9	0.54	3.3/3.0	1.5	3.25 to 12	4.3	32	.441 x (1)	1.84	388
3	2130160			17	33	4.7	17.2/15.8	7.9	1.0	4.8/4.4	2.2	3.25 to 12	4.9	40	.374 x (2)	2.62	507
3	2130165			21	33	4.7	17.2/15.8	7.9	1.0	4.8/4.4	2.2	3.25 to 12	4.9	40	.441 x (1)	1.84	449
5	2130170			11	33	4.7	17.2/15.8	7.9	1.0	4.8/4.4	2.2	3.25 to 12	5.5	72*	.441 x (2)	3.68	589
7.5	2130175			7	33	4.7	17.2/15.8	7.9	1.0x(2)	9.6/8.8	4.4	5 to 12	5.5	**	.441 x (3)	5.52	1124
10	2130180			11	33	4.7x(2)	34.4/31.6	15.8	1.0x(2)	9.6/8.8	4.4	3.25 to 12	5.5	**	.441 x (4)	7.36	1503
15	2130190			7	26	4.7x(2)	34.4/31.6	15.8	1.0x(2)	9.6/8.8	4.4	5.9 to 12	6.3	**	.441 x (6)	11.04	2244
20	2130195			6	26	4.7x(2)	34.4/31.6	15.8	1.0x(2)	9.6/8.8	4.4	6.5 to 12	6.3	**	.441 x (8)	14.72	2398

INVERTER CONTROL MOTORIZED TROLLEY

Cap. (Tons)	Model Number	Std. Lift (ft.)	Push Button Cord Length (ft.)	Lifting Speed (fpm)	Trolley Speed (fpm)	Hoist Motor			Trolley Motor			Flange Width Adjustability (in.)	Wheel Dia.	Min. Beam Radius (in.)	Load Chain Diameter (in.) X Chain Fall Lines	Add'l 1 ft. of Lift (lbs.)	Net Wt. (lbs.)
						HP	Amp. Draw		HP	Amp. Draw							
							208/230V	460V		208/230V	460V						
1	2130130-VFD	20	18	21/7	50/17	2.4	9.2/8.4	4.2	0.54	3.3/3.0	1.5	3.25 to 12	3.7	32	.280 x (1)	0.75	248
2	2130150-VFD			21/7	50/17	4.7	17.2/15.8	7.9	0.54	3.3/3.0	1.5	3.25 to 12	4.3	32	.441 x (1)	1.84	398
3	2130160-VFD			15/5	50/17	4.7	17.2/15.8	7.9	1.0	4.8/4.4	2.2	3.25 to 12	4.9	40	.374 x (2)	2.62	517
3	2130160-VFD-230-1			15/5	50/17	4.7	17.2/15.8	-	1.0	4.8/4.4	-	3.25 to 12	4.9	40	.374 x (2)	2.62	517
3	2130165-VFD			21/7	50/17	4.7	17.2/15.8	7.9	1.0	4.8/4.4	2.2	3.25 to 12	4.9	40	.441 x (1)	1.84	459
5	2130170-VFD			11/4	50/17	4.7	17.2/15.8	7.9	1.0	4.8/4.4	2.2	3.25 to 12	5.5	72*	.441 x (2)	3.68	599
7.5	2130175-VFD			7/3	50/17	4.7	17.2/15.8	7.9	1.0x(2)	9.6/8.8	4.4	5 to 12	5.5	**	.441 x (3)	5.52	1142
10	2130180-VFD			11/4	50/17	4.7x(2)	34.4/31.6	15.8	1.0x(2)	9.6/8.8	4.4	3.25 to 12	5.5	**	.441 x (4)	7.36	1528
15	2130190-VFD			7/3	40/13	4.7x(2)	34.4/31.6	15.8	1.0x(2)	9.6/8.8	4.4	5.9 to 12	6.3	**	.441 x (6)	11.04	2274
20	2130195-VFD			6/2	40/13	4.7x(2)	34.4/31.6	15.8	1.0x(2)	9.6/8.8	4.4	6.5 to 12	6.3	**	.441 x (8)	14.72	2428

* Applies to a beam flange width of 4" and over.

** Contact factory with application.

DIMENSIONS - MOTORIZED TROLLEY

1 TO 5 TON MOTORIZED TROLLEY HOISTS:

Figure A

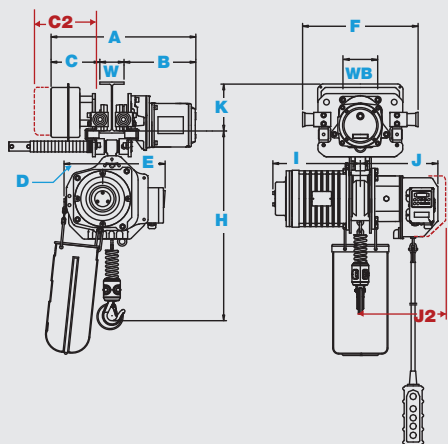
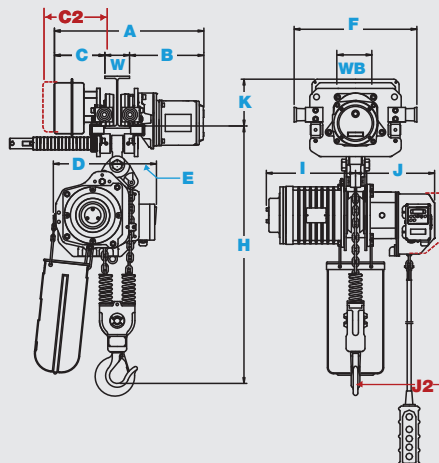

Figure B



Dimensions in Inches (Nominal). *For hook dimensions, see page 18.*

Model Number	A <small>W = Beam width</small>	B	C	C2*	D	E	F	H	I	J	J2*	K	WB	Figure
2130120	16.6 + W	9.9	6.7	-	6.7	7.5	16	21	12.1	10.8	-	6.5	4.4	A
2130130	16.6 + W	9.9	6.7	8.7	6.7	7.5	16	21	12.1	10.8	12.8	6.5	4.4	A
2130140	16.9 + W	10.1	6.8	-	8.9	5.3	16.7	29	12.1	10.8	-	6.4	4.9	B
2130150	16.9 + W	10.1	6.8	8.8	7.7	9.1	16.7	28	14.1	12.3	13.5	6.4	4.9	A
2130160	17.8 + W	10.9	6.9	8.9	10.2	6.6	18	36	14.1	12.3	13.5	6.2	5.5	B
2130160-VFD-230-1	19.8+W	10.9	8.9	8.9	10.2	6.6	18	36	14.1	13.5	13.5	6.2	5.5	B
2130165	17.8 + W	10.9	6.9	8.9	7.7	9.1	18	29	14.1	12.3	13.5	6.2	5.5	A
2130170	18.4 + W	11.2	7.2	9.2	10.7	6.1	20	42	14.1	12.3	13.5	6.3	6.1	B
2130175	18.2 + W	11.1	7.1	9.1	-	-	37.8	50	14.1	12.3	13.5	6.3	17.7	C
2130180	18.4 + W	11.2	7.2	9.2	-	-	37.4	49	14.1	14.1	14.1	6.3	17.3	D
2130190	20.3 + W	12.7	7.6	9.6	-	-	47	59	14.8	14.8	16	7.3	22.0	D
2130195	20.3 + W	12.7	7.6	9.6	-	-	47	59	15.9	15.9	17.1	7.3	22.0	D

* Inverter Control Models only.

7-1/2 TON MOTORIZED TROLLEY HOIST:

Figure C

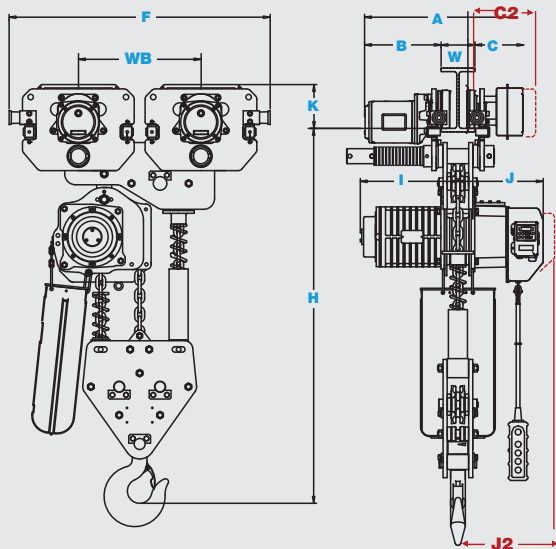

10 TON TO 20 TON MOTORIZED TROLLEY HOISTS:

Figure D

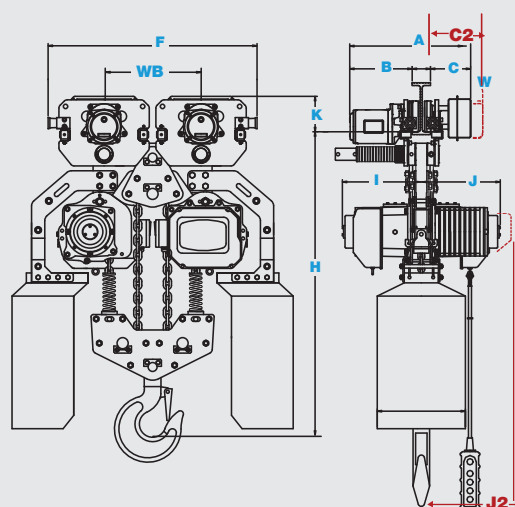

ACCOLIFT® HOISTS - HOOK DIMENSIONS & CHAIN CONTAINER CAPACITIES

ACCOLIFT® HOISTS - HOOK DIMENSIONS

Dimensions in Inches (Nominal)

Capacity	A	B	C	D	E
1 Ton	0.95	3.82	1.24	1.38	.93
2 Ton	1.18	5.73	1.69	2.11	1.54
3 Ton	1.38	6.63	1.93	2.36	1.77
5 Ton	1.71	7.48	2.17	2.76	2.21
7 1/2 Ton	2.17	9.21	3.43	3.54	3.05
10 Ton	3.15	12.72	4.65	4.72	3.35
15 Ton	3.15	12.72	4.65	4.72	3.35
20 Ton	3.15	12.72	4.65	4.72	3.35

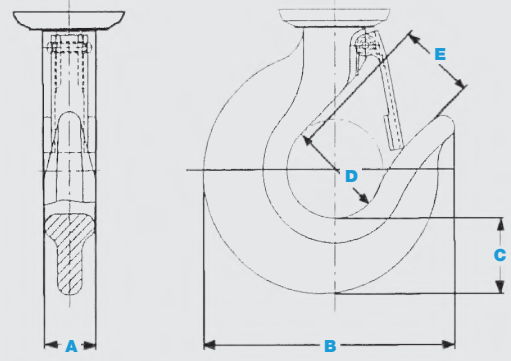

ACCOLIFT® HOISTS - CHAIN CONTAINER CAPACITIES

Model Number	Hoist Capacity	Max. Lift With Standard Chain Bucket (ft.)	Max. Lift With Optional Chain Bucket (ft.)	Max. Lift With Optional Canvas Chain Bag (ft.)
2130020 2130120	1T (17 FPM)	49 (71574-1038)	130 (71574-1039)	40 (71574-1264)
2130030 2130130	1T (27 FPM)	49 (71574-1038)	130 (71574-1039)	40 (71574-1264)
2130040 2130140	2T (13 FPM)	24 (71574-1038)	65 (71574-1039)	20 (71574-1264)
2130050 2130150	2T (27 FPM)	20 (71574-1038)	59 (71574-1039)	15 (71574-1264)
2130060 2130160	3T (17 FPM)	39 (71574-1039)	57 (71574-1293) 81 (71574-1253)	N/A
2130065 2130165	3T (21 FPM)	20 (71574-1038)	59 (71574-1039)	15 (71574-1264)
2130070 2130170	5T (11 FPM)	30 (71574-1039)	46 (71574-1293) 65 (71574-1253)	N/A
2130075 2130175	7.5T (7 FPM)	20 (71574-1039)	49 (71574-7239)	N/A
2130080 2130180	10T (11 FPM)	49 (71574-6239)	59 (71574-6239-2)	N/A
Steel buckets may be available for longer lifts than stated above - please call factory with your application. Buckets custom designed for 15T & 20T hoists as application requires.				

LOW HEADROOM HOISTS

LOW HEADROOM HOISTS - INVERTER CONTROL / MOTORIZED TROLLEY

Cap. (Tons)	Model Number	Std. Lift (ft.)	Push Button Cord Length (ft.)	Lifting Speed (fpm)	Trolley Speed (fpm)	Hoist Motor			Trolley Motor			Flange Width Adjustability (in.)	Wheel Dia.	Load Chain Diameter (in.) X Chain Fall Lines	Add'l 1 ft. of Lift (lbs.)	Net Wt. (lbs.)
						HP	Amp. Draw		HP	Amp. Draw						
							208/230V	460V		208/230V	460V					
1	2230120-VFD-L	20	18	17/6	75/25	2.0	8.8/8.0	4.0	0.54	3.3/3.0	1.5	3.25 to 12	3.7	.280 X (1)	0.75	330
2	2230140-VFD-L			9/3	75/25	2.0	8.8/8.0	4.0	0.54	3.3/3.0	1.5	3.25 to 12	4.3	.280 X (2)	1.5	378
3	2130160-VFD-L			15/5	65/22	4.7	17.2/15.8	7.9	1.0	4.8/4.4	2.2	3.25 to 12	5	.374 X (2)	2.68	617
5	2130170-VFD-L			11/4	65/22	4.7	17.2/15.8	7.9	1.0	4.8/4.4	2.2	3.25 to 12	5.5	.441 X (2)	3.68	713

Figure A

(Refer to page 3 for hoist features.)

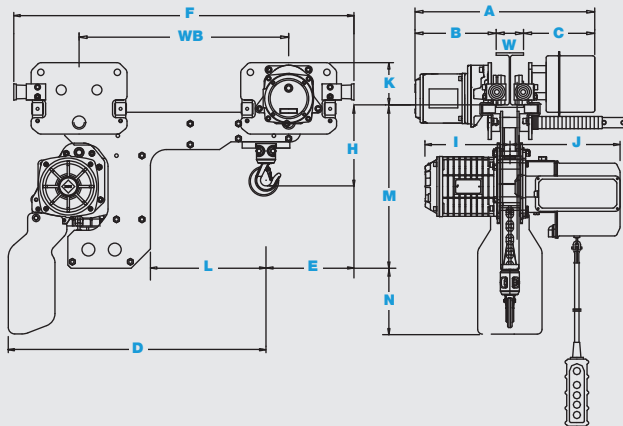

Figure B

(Refer to page 3 for hoist features.)

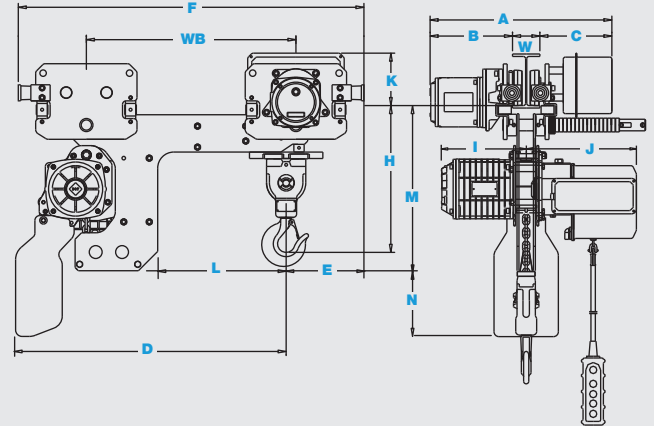
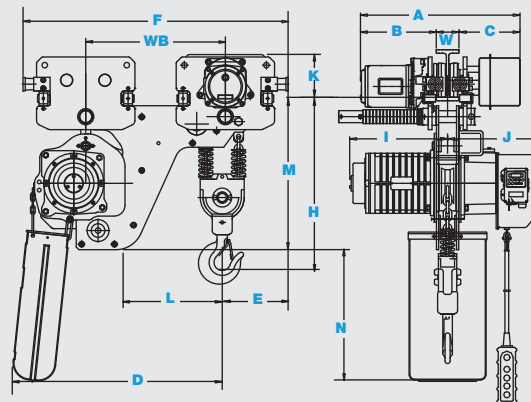

Figure C

(Refer to page 11 for hoist features.)



Dimensions in Inches (Nominal). **For hook dimensions, see page 20.**

Model Number	A	B	C	D	E	F	H	I	J	K	L	M	N	WB	Figure
2230120-VFD-L	18.5+W	10	8.5	30.7	10.8	41.5	10.3	10.4	13.5	5.2	14	20	8	25.5	A
2230140-VFD-L	18.9+W	10.1	8.8	33	9.5	42.5	17.9	10.4	13.5	5.2	15	20	8	25.5	B
2130160-VFD-L	19.6+W	10.9	8.7	28.6	9.6	38.2	23.6	14.1	13.5	5.8	15	22	19	20	C
2130170-VFD-L	20.4+W	11.2	9.2	30.1	10	40.1	27.2	14.1	13.5	6.1	15	22.4	19	20	C

LOW HEADROOM HOISTS

LOW HEADROOM HOISTS - HOOK DIMENSIONS

Dimensions in Inches (Nominal)

Capacity	A	B	C	D	E
1 Ton	0.95	3.82	1.24	1.38	0.93
2 Ton	1.18	5.73	1.69	2.11	1.54
3 Ton	1.38	6.63	1.93	2.36	1.77
5 Ton	1.71	7.48	2.17	2.76	2.21

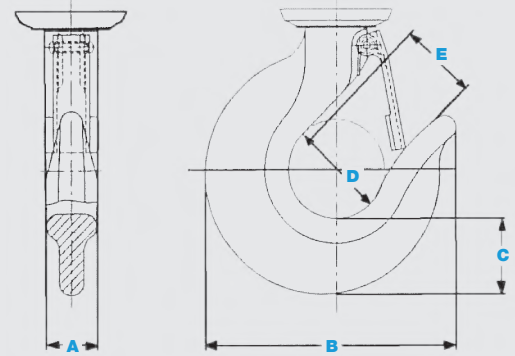

LOW HEADROOM HOISTS - CHAIN CONTAINER CAPACITIES

Model Number	Hoist Capacity	Max. Lift With Standard Chain Bucket (ft.)	Max. Lift With Optional Chain Bucket (ft.)	Max. Lift With Optional Canvas Chain Bag (ft.)
2230120-VFD-L	1T	39 (71964-1132)	49 (71574-1038)	40 (71574-1264)
2230140-VFD-L	2T	25 (71965-2132) or (71574-1038)	65 (71574-1039)	20 (71574-1264)
2130160-VFD-L	3T	39 (71574-1039)	57 (71574-1293) 81 (71574-1253)	N/A
2130170-VFD-L	5T	30 (71574-1039)	46 (71574-1293) 65 (71574-1253)	N/A

